

# Important Instructions

**Subject** Disassembly of the 13 Inch Roll Heated Flatwork Finisher  
**Use With** Models UD13F063 and UD13F078

The roll heated flatwork finisher is delivered as one unit that is approximately 108 inches x 26 inches x 44.5 inches. The press must be disassembled in order to fit through a 36 inch door opening.

**IMPORTANT:** These instructions must be carried out by a qualified service person with experience in steam and electrical connections.

**IMPORTANT:** Minimum of 2 people required to complete disassembly.

**Tools Needed:**

- Phillips head screwdriver
- Allen wrenches (5 mm, 10 mm)
- Drift punch
- Flat head screwdriver

	<b>CAUTION</b>
<p>If using a forklift to move press, exercise care that forklift arms are inserted under the frame and do not contact any operating mechanism.</p>	
<small>W431</small>	

	<b>WARNING</b>
<p>To avoid serious injury use caution when separating press. Sections can become unstable if not supported correctly.</p>	
<small>W432</small>	

1. Remove front, side, top and rear panels. Refer to *Figure 1*.

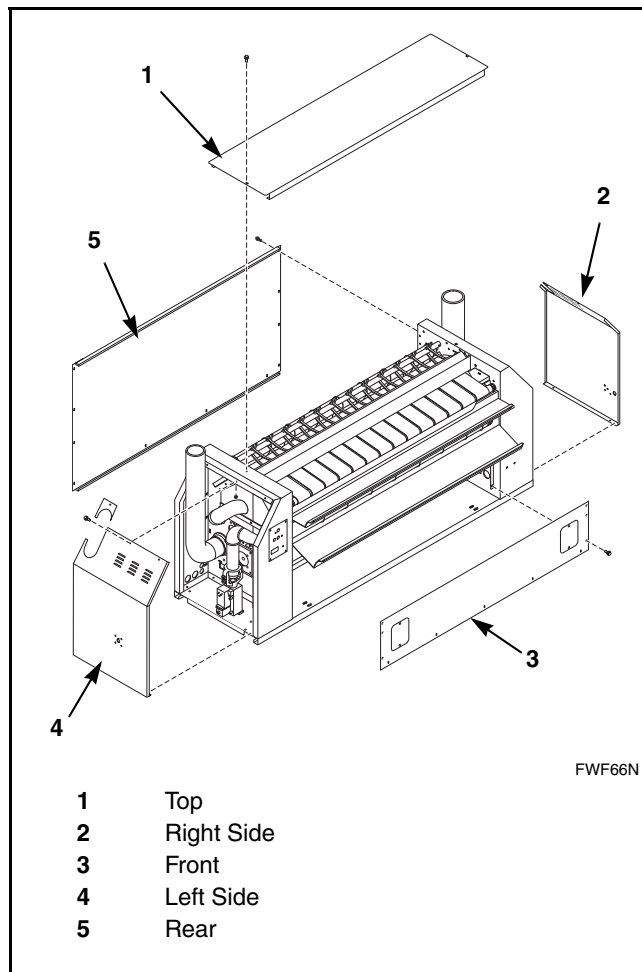
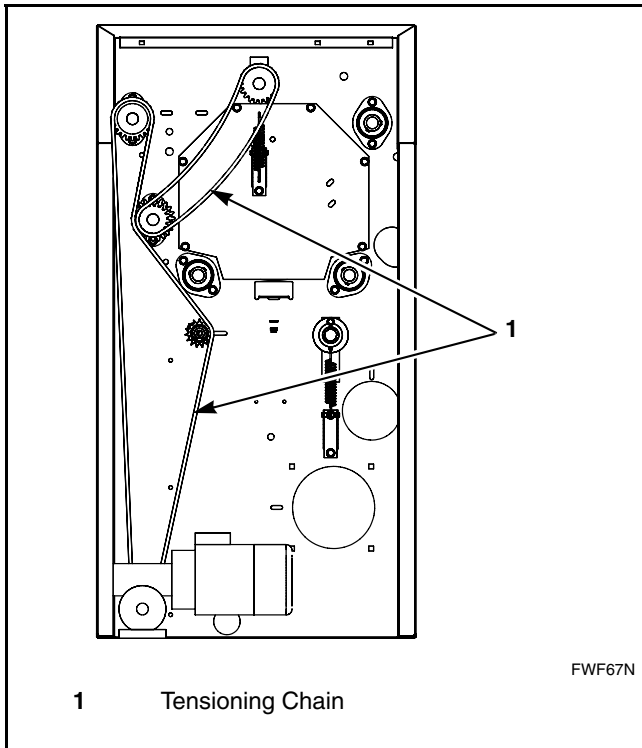

Figure 1

2. Remove chain tensioner from right side of machine. Refer to *Figure 2*.



1 Tensioning Chain

Figure 2

3. Remove feeding bands.

- a. With a standard screwdriver, pop clamp open at left end of feeding roller. Refer to *Figure 3*.

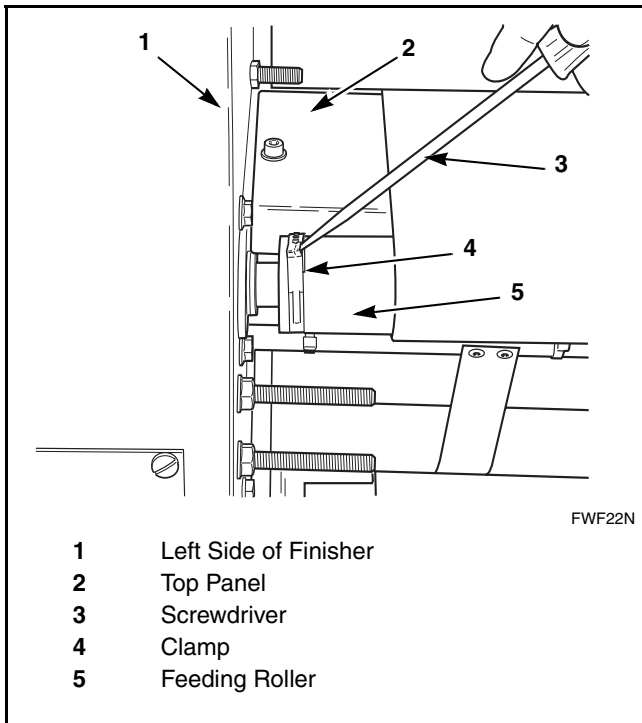

1 Left Side of Finisher  
 2 Top Panel  
 3 Screwdriver  
 4 Clamp  
 5 Feeding Roller

Figure 3

- b. Remove clamp from roll.
- c. Peel back adhesive strip from left side of feeding roller to expose roll pin. Refer to *Figure 4*.

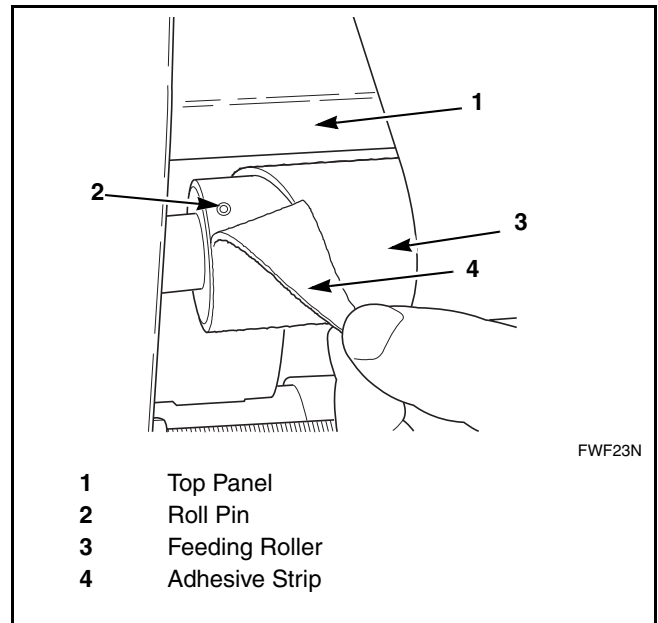

1 Top Panel  
 2 Roll Pin  
 3 Feeding Roller  
 4 Adhesive Strip

Figure 4

- d. Using a center punch, completely knock out feeding roll pin. Refer to *Figure 5*.

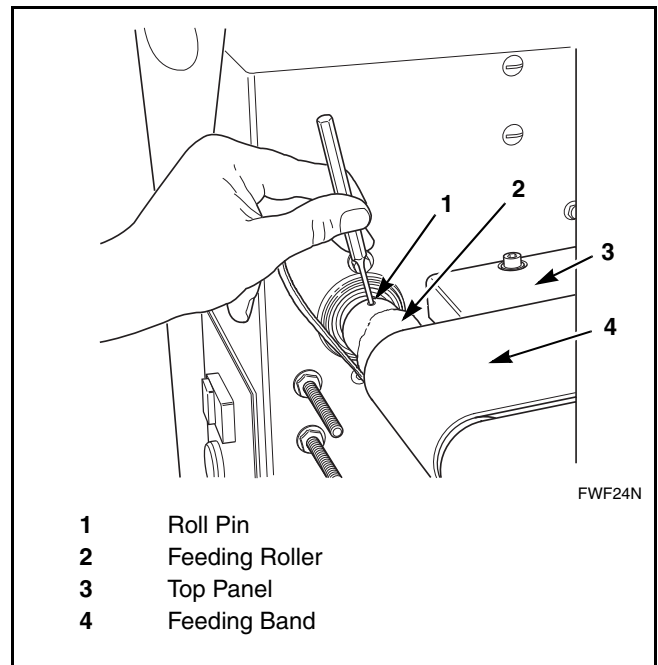

1 Roll Pin  
 2 Feeding Roller  
 3 Top Panel  
 4 Feeding Band

Figure 5

- e. Remove screw from left side of top panel (behind feeding roller) Refer to *Figure 6*.

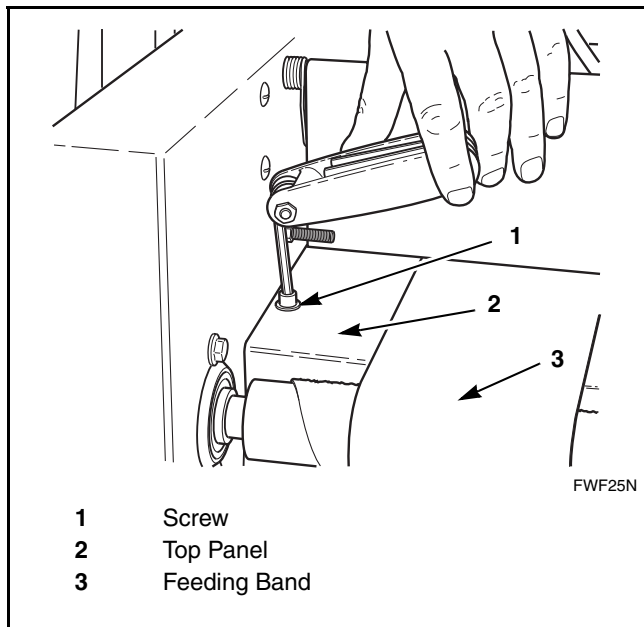

Figure 6

- f. Unlock the feeding band roller at the left side interior panel by removing two screws. Keep roller in place and check the direction in which the bearing is mounted. Refer to *Figure 7*.

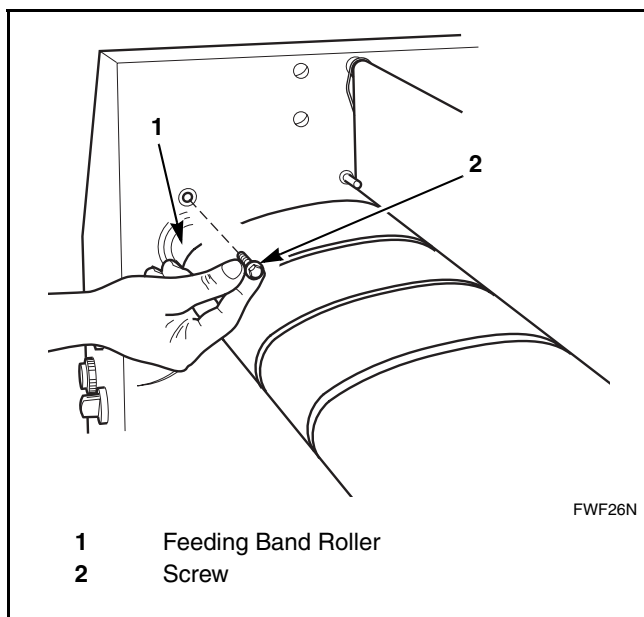

Figure 7

- g. Remove bearing by pressing left. Refer to *Figure 8*.

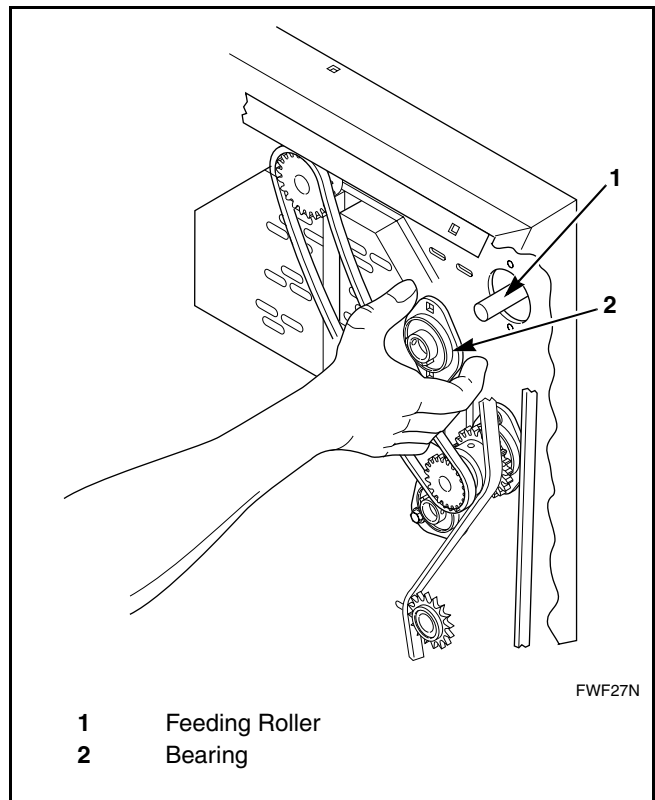

Figure 8

- h. Remove feeding bands by sliding to left side of roller.

4. Remove ironing bands.
  - a. Locate the ironing band tension systems on each side of the finisher. Refer to *Figure 9*.
  - b. Remove tension screw and bracket from press-roller tension spring on each side of finisher.

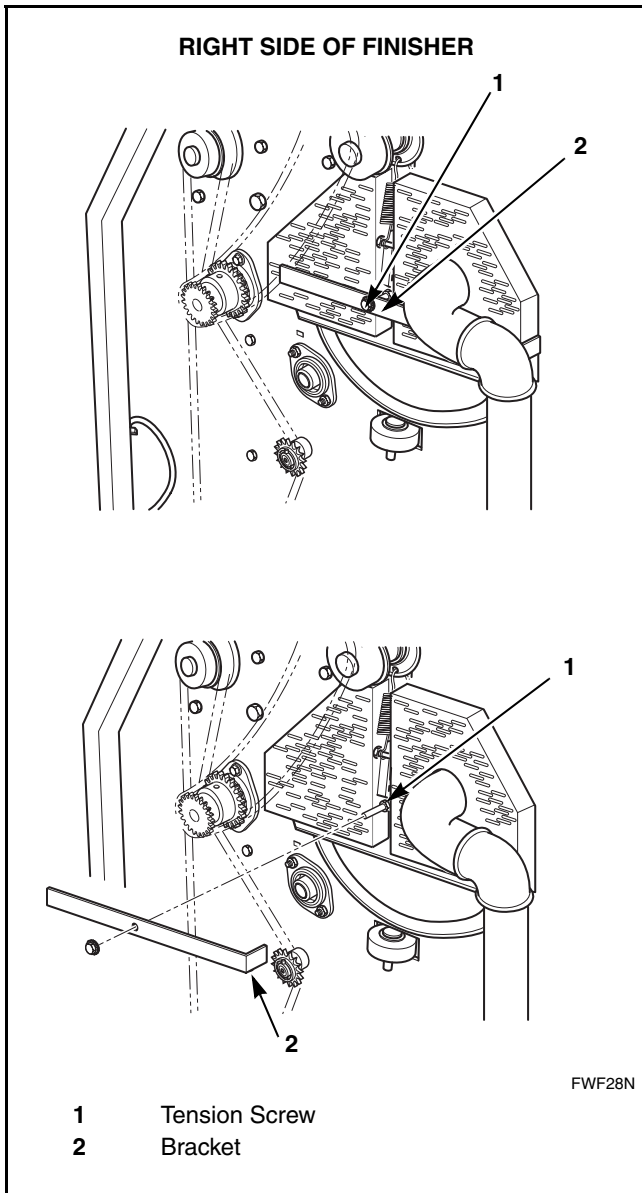

Figure 9

- c. Unhook the ironing band tension spring from the tension pin on each side of finisher. Refer to *Figure 10*.

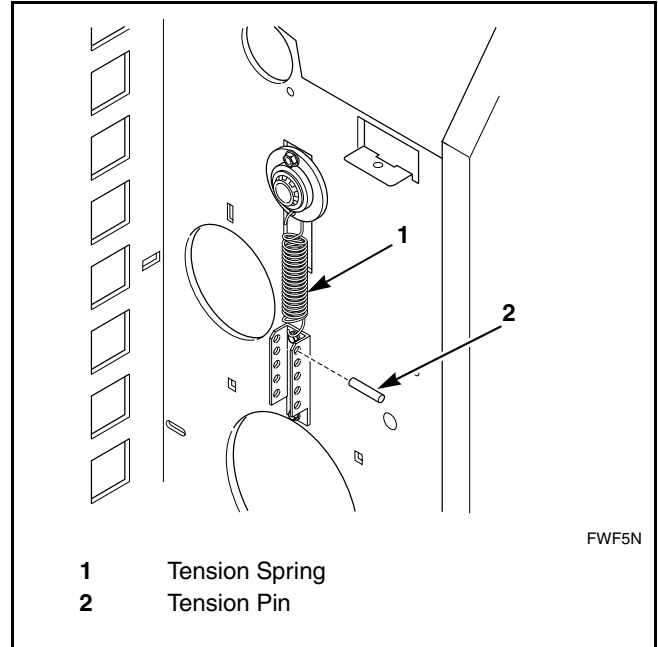

Figure 10

- d. Use manual crank to move cylinder until ironing band connection point is at top of rear drive roller.
  - e. Remove pin from teeth of ironing band. Refer to *Figure 11*.

**NOTE: Do not release bottom portion of ironing band.**

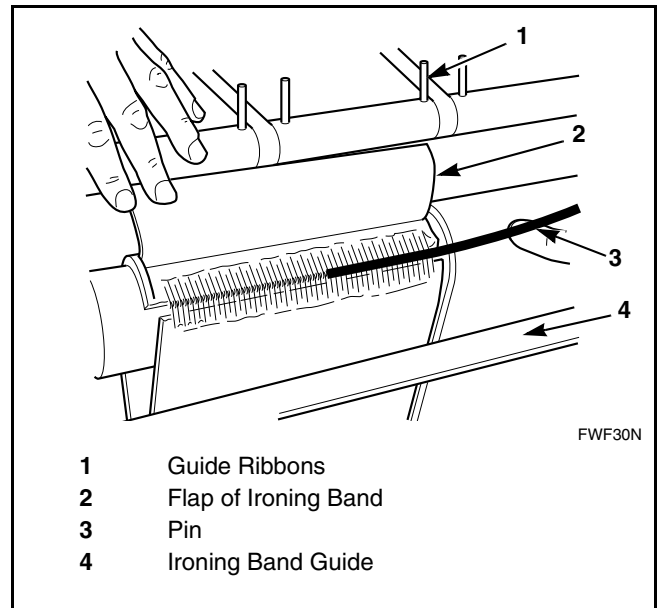



Figure 11

5. Remove guide ribbons by removing staples. Refer to *Figure 11*.
6. Remove finger guards.
7. Remove hardware attaching rollers to right side, including screws, sprockets, collars and bearings. Refer to *Figure 12*.
8. Remove rollers by pulling through to the left side of the machine.
9. Use a forklift to support the cylinder before going any further.

**NOTE: Cylinder weighs approximately 300-400 pounds. It must not be tipped.**

10. Disconnect electrical wires from the pressure switch, fan motor, drive motor and side panel switch. Pull wires through to the left side of the machine.

11. Remove right frame. Refer to *Figure 1*.

	<b>WARNING</b>
<p><b>To avoid serious injury use caution when separating press. Sections can become unstable if not supported correctly.</b></p>	
<p>W432</p>	

12. Remove cylinder from machine using forklift to support.
13. Remove left frame. Refer to *Figure 1*.
14. Reassemble press using reverse order of these instructions.

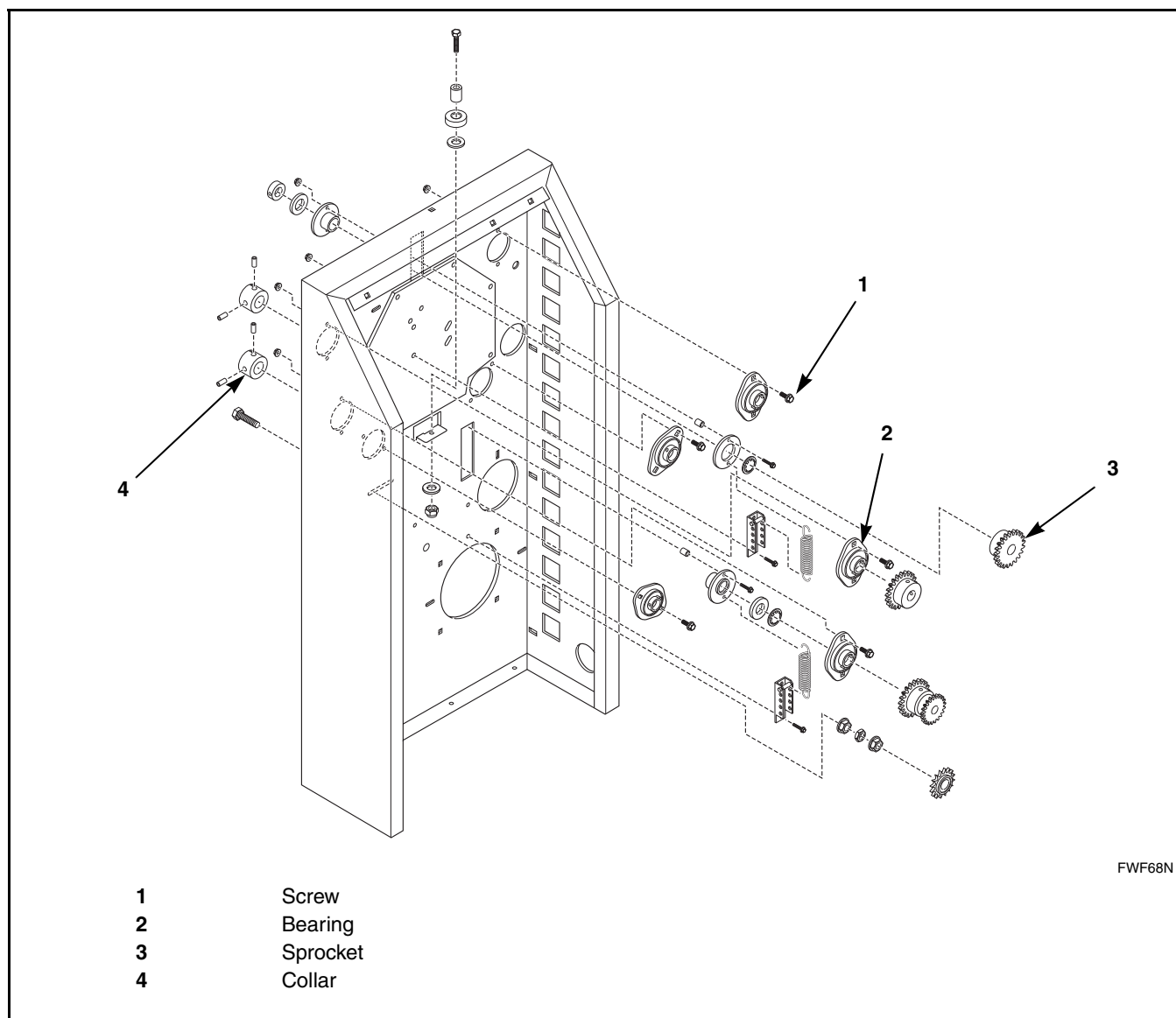

Figure 12